

SHARP

FX-J80J

AIR PURIFIER OPERATION MANUAL



HIGH-DENSITY 25000 *

“Plasmacluster” and “Device of a cluster of grapes” are trademarks of Sharp Corporation.



* The number in this technology mark indicates an approximate number of ions supplied into air of 1 cm^3 , which is measured around the center of a room applicable floor area (at 1.2 m height above the floor) when the product is placed close to a wall at the MED mode setting.

A unique Combination of Air Treatment Technologies Triple Filtration System + Plasmacluster



High Density Plasmacluster 25000
The higher the PCI density is, the more effective PCI has.

HIGH-DENSITY 25000 *

Triple Filtration System

TRAP DUST

Pre-filter traps dust larger than approx 240 micron particles.

DECREASES ODORS

Deodorizing filter absorbs many common household odors.

REDUCES TINY DUST, POLLEN & MOLD

HEPA filter traps 99.97% of particles as small as 0.3 microns.

Unique Airflow

Powerful air suction and unique airflow quickly and efficiently collect dust and other particles.

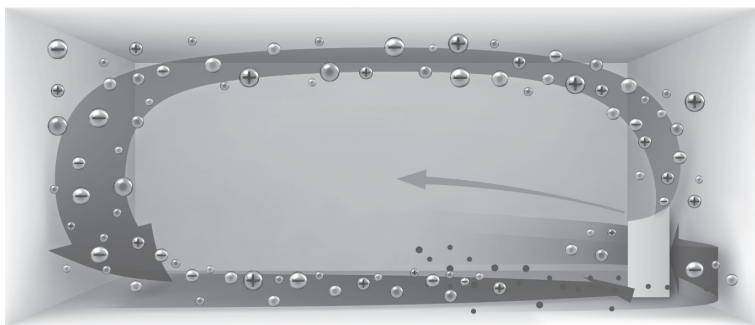

Faster airflow at a 20° angle collects dust at lower levels in the room for more effective cleaning.

Plasmacluster can remove static electricity and can thus prevent dust from attaching to walls and other surfaces.

Plasmacluster

By emitting a balance of positive and negative ions, Plasmacluster air treatment is a natural process.

PM2.5 Monitor

- Inform by lighting PM2.5 monitor when Sensitive Dust sensor detects microscopic dust.
- Display the value of PM2.5 in 3 digits. (The displayed numbers are approximate.)

Plasmacluster Ion Spot Mode

- Recommended when odor and germs adhering to sofa and curtains are concerned.
- Emits highdensity Plasmacluster Ions only in the forward directions.

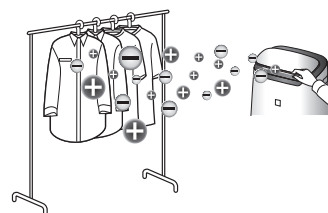

This appliance is intended for indoor domestic use only.

Thank you for purchasing this SHARP Air Purifier.
Please read this manual carefully before using the product.
This manual should be kept in a safe place for handy reference.

CONTENTS

IMPORTANT SAFETY INSTRUCTIONS	2
CARE AND MAINTENANCE	4
REPLACEMENT	5
PART NAMES	6
PREPARATION	8
OPERATION	9
TROUBLESHOOTING	12
SPECIFICATIONS.....	13

Please read before operating your new Air Purifier

The air purifier draws in room air through the air inlet, circulates it through a Pre-Filter, a Deodorizing Filter and a HEPA Filter inside the main unit, and then discharges it through the air outlet. The HEPA Filter can remove 99.97% of dust particles as small as 0.3 microns that pass through the filter and also helps absorb odors. The Deodorizing Filter gradually absorbs odors as they pass through the filter.

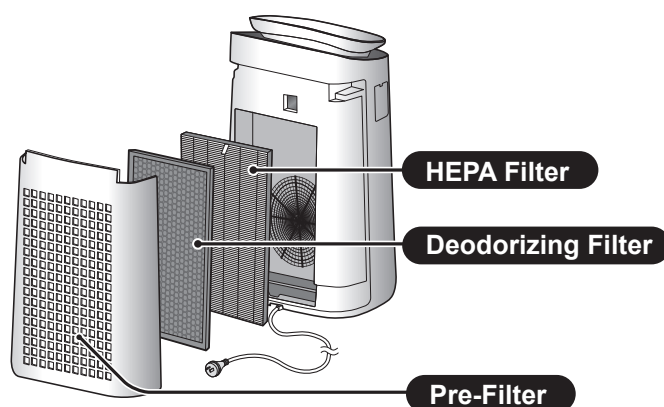

Some odors absorbed by the filters will break down over time, causing additional odors. Depending on usage conditions, and especially if the main unit is used in environments significantly more severe than a normal household, these odors may become noticeable sooner than expected. If these odors persist, replace the filters.

NOTE

- The air purifier is designed to remove air-suspended dust and the odors.
The air purifier is not designed to remove harmful gases such as carbon monoxide contained in cigarette smoke.
The air purifier may not completely remove an odor if the source of the odor is still present.

IMPORTANT SAFETY INSTRUCTIONS

Always follow basic safety precautions when using electrical appliances, including the following:

WARNING – Always observe the following to reduce the risk of electrical shock, fire, or injury:

- Read all instructions before using the main unit.
- Use only a 220 - 240 volt outlet.
- **This appliance is not intended for use by persons (including children) with reduced physical, sensory or mental capabilities, or lack of experience and knowledge, unless they have been given supervision or instruction concerning use of the appliance by a person responsible for their safety. Children should be supervised to ensure they do not play with the appliance.**
- **If the power cord is damaged, it must be replaced by the manufacturer, its service agent, a Sharp authorized Service Center or similarly qualified persons in order to avoid a hazard. Contact the nearest Service Center for any problems, adjustments, or repairs.**
- **Do not repair or disassemble the main unit yourself.**
- **Be sure to remove the power plug, before performing maintenance, when removing and attaching and replacing the filter and when not using for a long time. Failure to do so can cause a short circuit resulting in electrical shock or fire.**
- Do not use the main unit if the power cord or plug is damaged or if the connection to the wall outlet is loose.
- Periodically remove dust from the plug.
- Do not insert fingers or foreign objects into the air inlet or air outlet.
- When removing the power plug, always hold the plug and never pull on the cord. Failure to do so can cause a short circuit resulting in electrical shock or fire.

- Be careful not to damage the power cord.
Failure to do so can cause electric shock, heat generation, or fire.
- Do not remove the plug when your hands are wet.
- Do not use this main unit near gas appliances or fireplaces. When the main unit is operated with gas appliances in same room, Ventilate a room periodically, otherwise it may cause Carbon monoxide poisoning.
- Do not operate the main unit in rooms where aerosol insecticides are present. Do not operate the main unit in rooms where there is oily residue, incense, sparks from lit cigarettes, or chemical fumes in the air.
- Keep the main unit away from water. Do not operate the main unit in places where it may get wet, such as a bathroom.
- Do not expose the main unit to water. Doing so can cause a short circuit or electrical shock.
- Be cautious when cleaning the main unit. Strong corrosive cleansers can damage the exterior.

NOTE – What to do if the main unit interferes with radio or TV reception

If the air purifier interferes with radio or television reception, try one or more of the following measures:

- Adjust or reposition the receiving antenna.
- Increase the distance between the main unit and the radio or TV.
- Connect the equipment into an outlet on a circuit different from that of the radio or TV receiver.
- Consult the dealer or a qualified radio or TV technician.

CAUTIONS CONCERNING OPERATION

- Do not block the air inlet or air outlet.
- Do not place the main unit near or on hot objects, such as stoves or heaters, or where it may come into contact with steam.
- Always operate the main unit in an upright position.
- Do not move the main unit when it is in operation.
- When moving the main unit, use the handles on both sides.
- If the main unit is on easily damaged flooring, an uneven surface, or thick-piled carpet, lift it up when moving.
- Do not operate the main unit without the filters properly installed.
- Do not wash and reuse the HEPA filter and the Deodorizing filter.
Doing so will not improve filter performance and can also cause electric shock or operating malfunctions.
- Clean the exterior with a soft cloth only. Do not use volatile fluids or detergents. The main unit surface may be damaged or cracked with Benzine, paint thinner or polishing powder. In addition, the sensors may malfunction as a result.
- Do not scrub the Back Panel hard during its maintenance.

INSTALLATION GUIDELINES

- Avoid locations where the sensors are exposed to direct wind.
Doing so can cause the main unit to malfunction.
- Avoid locations where furniture, fabrics, or other objects can come in contact with the main unit and interfere with the intake and outtake of air.
- Avoid locations where the main unit is exposed to condensation or drastic changes in temperature. Appropriate room temperature is between 0 – 35 °C.
- Place the main unit on a level and stable surface with sufficient air circulation. When placed on heavy carpet, the main unit may vibrate slightly.
- Avoid locations that generate grease or oily smoke.
Doing so can cause the main unit exterior to crack and the sensors to malfunction.
- The dust collecting ability of the main unit is effective even when the main unit is as close to 3 cm from the wall, the surrounding walls and floor may get dirty. Please place the main unit at a distance from the wall.
The wall directly behind the air outlet may become dirty over time. When using the main unit for an extended period of time at the same location, periodically clean the walls adjacent to it.

FILTER GUIDELINES

- Follow the instructions in this manual for proper filter care and maintenance.
(Page 4)

CARE AND MAINTENANCE

Always be sure to remove the power plug from the wall outlet.

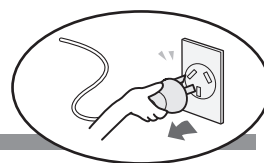

MAIN UNIT / BACK PANEL (Pre-Filter)

Wipe with a dry, soft cloth

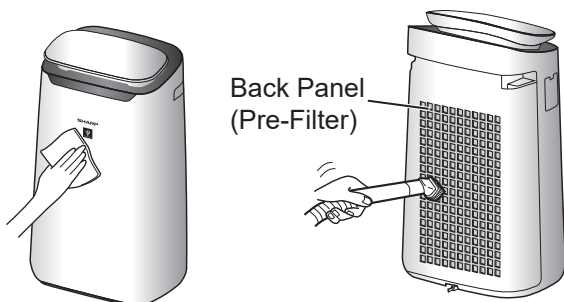

Remove the dust gently with a cleaning tool such as a vacuum cleaner.

NOTE How to clean hard to remove dirt.

Back Panel

1. Add a small amount of neutral detergent to water and soak for about 10 minutes.

CAUTION

Do not apply excessive pressure when scrubbing the back panel.

2. Rinse off the neutral detergent with clean water.
3. Completely dry the filter in a wellventilated area.

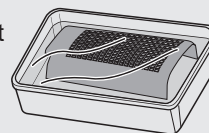

Sensor Filter

1. Remove the Back Panel.
2. Remove the sensor filter.
3. If the sensor filter is very dirty, wash it with water and dry it thoroughly.

Sensor Filter

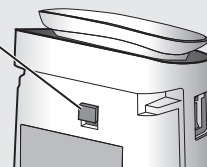

HEPA FILTER / DEODORIZING FILTER

Remove the dust on the filters.

CAUTION Do not wash the filters. Do not expose to sunlight. (Otherwise these filters may lose efficacy.)

HEPA FILTER

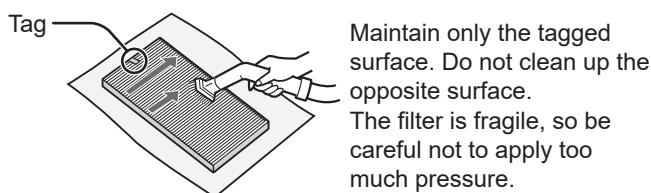

DEODORIZING FILTER

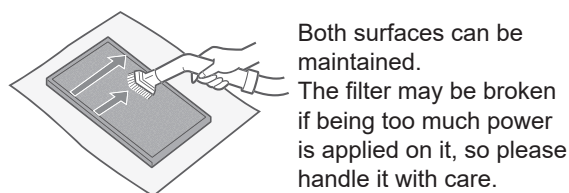

Some odors absorbed by the filters will break down over time, causing additional odors. Depending on usage conditions, and especially if the Main Unit is used in environments significantly more severe than a normal household, these odors may become noticeable sooner than expected.

Replace the filter in those cases or if dust is unable to be removed after maintenance.

Plasmacluster Ion Generating Unit (electrode section)

1. Remove the unit cover, and pull out the unit holder.

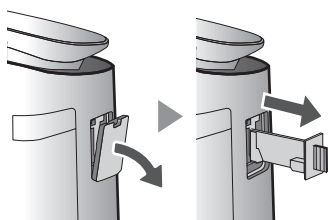

2. Remove dusts from the electrode section.

Unit Cleaning Brush

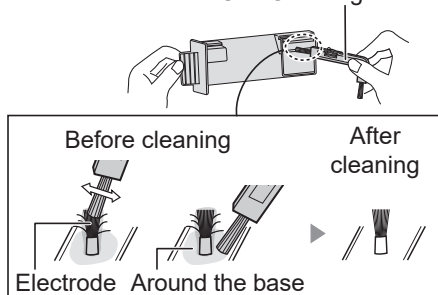

3. Insert the unit holder in the Main Unit, and install the unit cover.

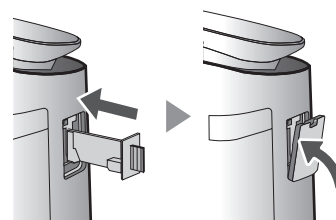

CAUTION

- Do not clean with anything other than the unit cleaning brush. Doing so could lead to failures in the unit.
- A bent electrode could be cut off and dropped during the cleaning process, but it will not change the performance.
- Do not touch the electrode directly. Doing so could lead to pain/itching.
- Do not transform the electrode section. Doing so can damage it.
- Do not touch the connection terminals. Doing so can damage them.

REPLACEMENT

Always be sure to remove the power plug from the wall outlet.



HEPA FILTER / DEODORIZING FILTER

LIFE OF FILTERS

Filter life varies depending on the room environment, usage conditions, and location of the Main Unit. Lifespan of HEPA filter and Deodorizing filter and replacement suggestions are based on purifying a room in which 5 cigarettes are smoked per day and the Main Unit's dust collection and deodorizing performance has declined to half the level of a new filter.

We recommend replacing the filter more frequently if the Main Unit is used in conditions significantly more severe (PM2.5 etc.,) than a normal household.

- HEPA Filter About 2 years after opening
- Deodorizing Filter About 2 years after opening

FILTER REPLACEMENT INDICATOR

When the filter replacement is needed soon, the filter indicator lamp start blinking. the blinking speed becomes faster once the timing comes.

Filter life varies depend on the operation mode.



Replace the Filter according to the instructions provided with the replacement filter.

After performing replacement, reset the Filter Replacement Indicator.

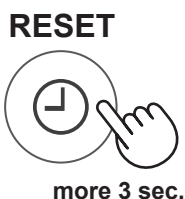

Replacement Filter Model

Consult your dealer when purchasing a replacement filter.

HEPA Filter (1 unit)
FZ-J80HFE

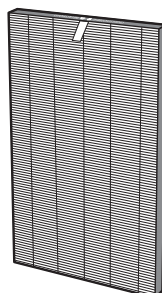

Deodorizing Filter (1 unit)
FZ-J80DFE

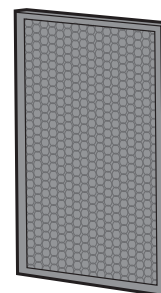

Disposing of filters

Dispose of used filters according to local laws and regulations.

HEPA Filter material:

- Polypropylene
- Polyethylene



Deodorizing Filter material:

- Polypropylene
- Polyester
- Activated carbon

Plasmacluster Ion Generating Unit

UNIT REPLACEMENT INDICATOR

When the total operation time exceeds 17,500 hours, the Unit Replacement indicator will flash to indicate that the Plasmacluster Ion Generating Unit needs replacement.

Operating time	
17,500 hours	Replace the Plasmacluster Ion Generating Unit
 Flash slowly	
19,000 hours	Stop the emission of the Plasmacluster ions.
 Flash quickly	

* The replacement time is not related to the selected operation mode.

Replacement Plasmacluster Ion Generating Unit Model

Consult your dealer when purchasing a replacement Plasmacluster Ion Generating Unit.

IZ-C90ME

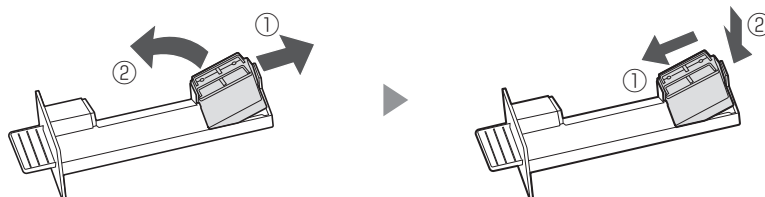

Remove the claw of unit holder (①), and remove the Plasmacluster Ion Generating Unit (②).

Disposing of Plasmacluster Ion Generating Unit

Dispose of used Plasmacluster Ion Generating Unit according to local laws and regulations.

material:

- Polybutylene terephthalate
- electronic parts

PART NAMES

MAIN UNIT

(FRONT)

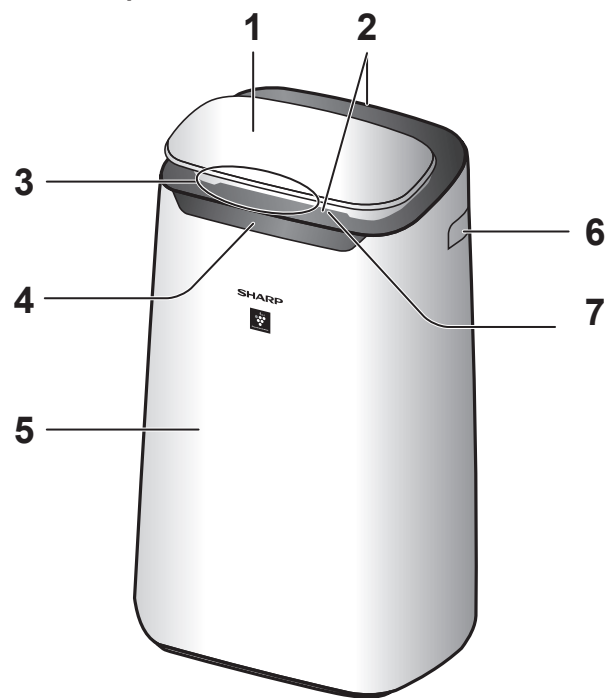

1	Operation Panel
2	Air Outlet (Front / Back)
3	Cleanliness Monitor
4	Front Display
5	Main Unit
6	Handle (2 Locations: Left and Right)
7	Front Louver
8	Back Panel (Pre-Filter)
9	Air Inlet
10	Deodorizing Filter
11	HEPA Filter
12	Sensor Filter
	Sensor (Internal) / Odor / Dust(sensitive)
13	Unit* (Plasmacluster Ion Generating Unit)
14	Unit* Holder
15	Unit* Cover
16	Unit* Cleaning Brush
17	Power Cord, Plug

(BACK)

* The Unit refers to Plasmacluster Ion Generating Unit.

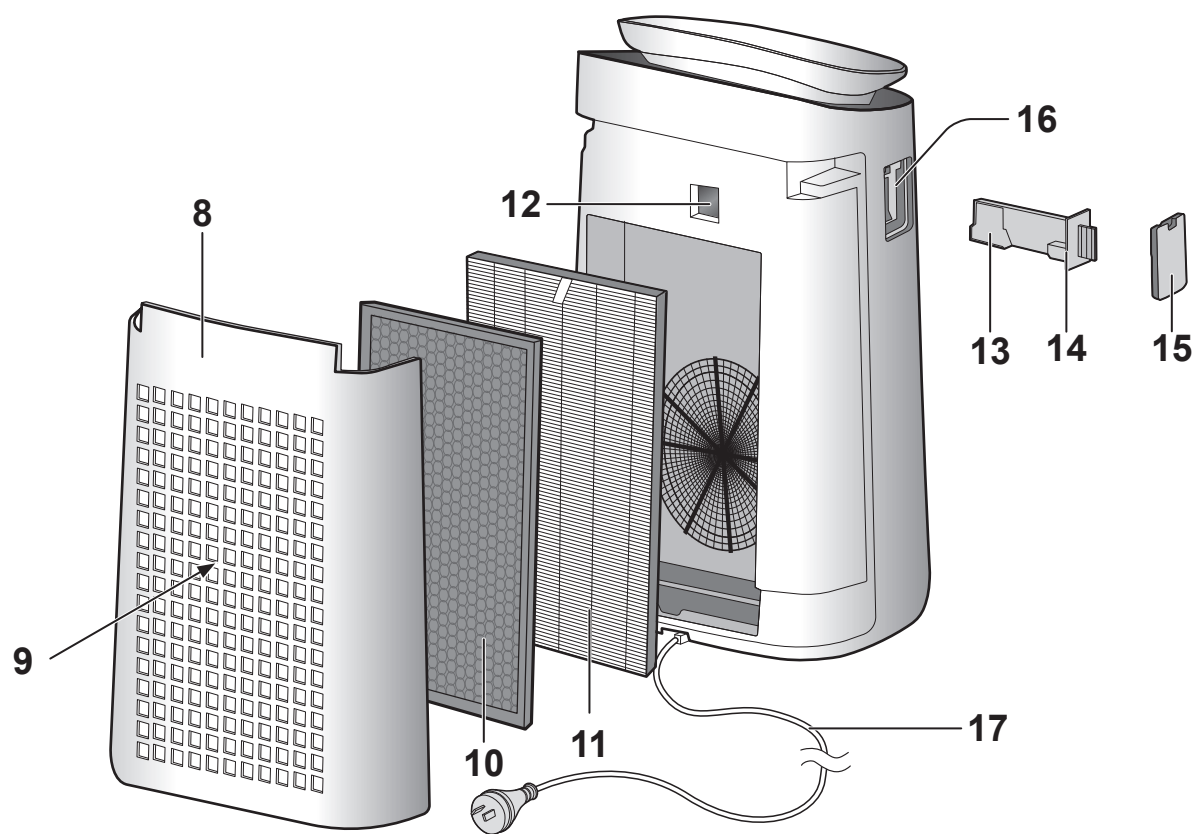

OPERATION PANEL

Press the button with “★” to start.

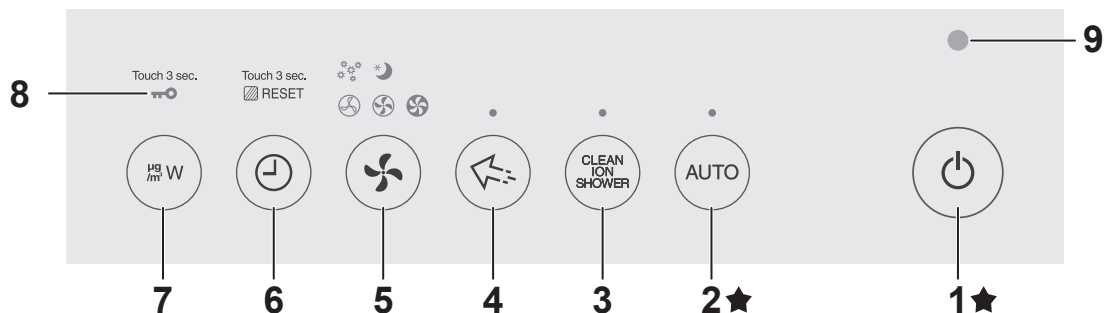

FRONT DISPLAY

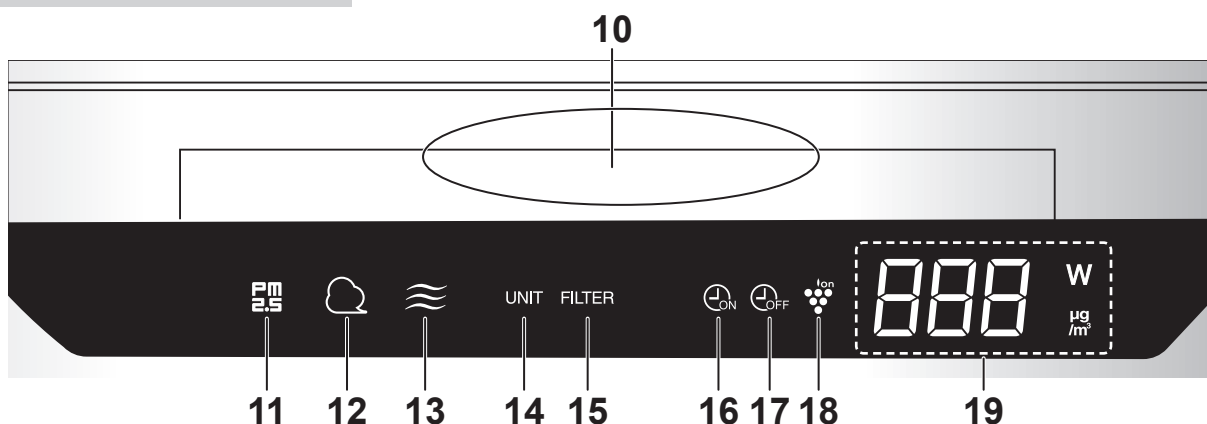

1	Power ON/OFF Button	11	PM2.5 Monitor Indicates the Dust(sensitive) Sensor detects microscopic dust.
2	AUTO Button, Indicator Light	12	Dust Monitor Indicates the Dust(sensitive) Sensor detects usual dust.
3	CLEAN ION SHOWER Button, Indicator Light	13	Odor Monitor Indicates the Odor Sensor detects odors.
4	Plasmacluster Ion SPOT Button, Indicator Light	<div style="display: flex; align-items: center; justify-content: center;"> <div style="text-align: center;">TURN OFF Clean</div> <div style="margin: 0 10px;">←→</div> <div style="text-align: center;">Orange Impure</div> </div>	
5	MODE Button, Indicator Light	14	Unit Replacement Indicator Light
6	Timer Button	15	Filter Replacement Indicator Light
6	(Press 3 sec.) FILTER RESET Button	16	ON Timer Indicator Light
7	DISPLAY Button	17	OFF Timer Indicator Light
7	(Press 3 sec.) CHILD-LOCK Button	18	Plasmacluster Ion Light
8	Child-Lock Indicator Light	19	DISPLAY
9	Light Sensor		<ul style="list-style-type: none"> • PM2.5 Monitor PM2.5 10 µg/m³ to 499 µg/m³ is displayed. 9 µg/m³ or less Lo ↔ 34 ↔ Hi 500 µg/m³ or more • Wattage Monitor Indicates wattage by current operation. • Timer Monitor Indicates setting time or remaining time of ON/OFF timer. 124
10	Cleanliness Monitor Indicates the air purity of the room in 5 levels with color changes. <div style="display: flex; align-items: center; justify-content: center;"> <div style="text-align: center;">Blue Clean</div> <div style="margin: 0 10px;">←→</div> <div style="text-align: center;">Red Impure</div> </div>		

PREPARATION

Always be sure to remove the power plug from the wall outlet.



FILTER INSTALLATION

1. Remove the Back Panel.

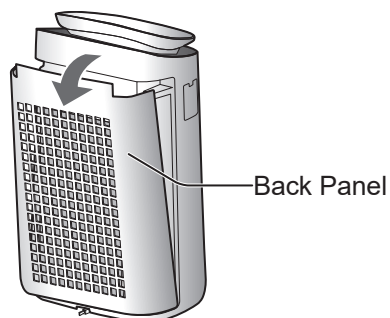

2. Remove the plastic bag from the each filter.

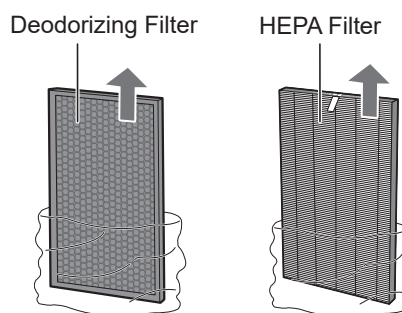

3. Install the filters in the correct order as shown.

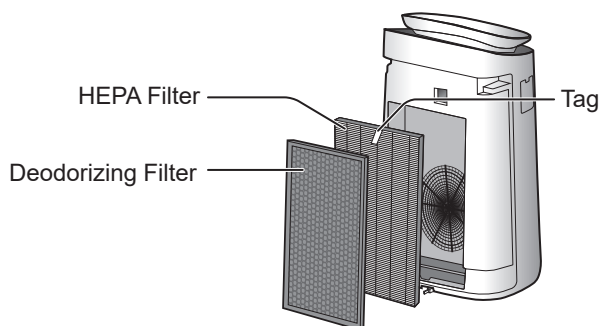

4. Install the Back Panel.

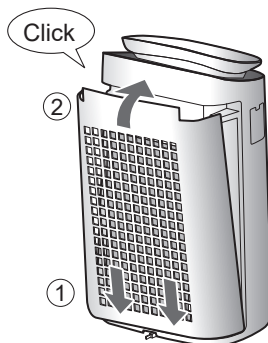

OPERATION

START/STOP

START

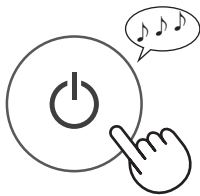

STOP

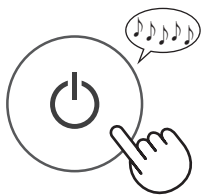

AUTO MODE

The fan speed is automatically controlled depending on the 3 detection. (Dust(sensitive) / Odor / Light)



NOTE

- Front Display, Cleanliness Monitor automatically switch ON and OFF based on room brightness. (When light control is set to "Auto". (Page 11))

CLEAN ION SHOWER MODE

The unit releases Plasmacluster ions with strong airflow and collects dusts while decreasing static electricity for 10 minutes. After that, the DUST sensor sensitivity is automatically increased and quickly detects impurities and clean the air powerfully for 50 minutes.



NOTE

- When the operation finishes after 60 minutes, the main unit will return to the prior operation mode. It is able to change the other mode during this mode.
- The Plasmacluster Ion can not be turned "OFF".

PLASMACLUSTER ION SPOT MODE

Use this mode when you want to remove adhering odor, germs, and other substances from cloths, sofas and curtains.

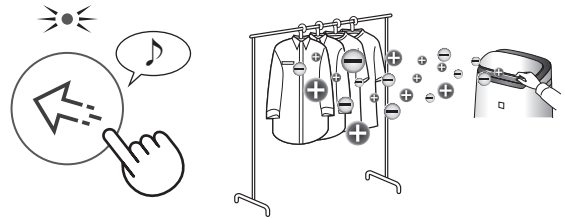

Adjust Front Louver manually.

NOTE

- Emits highdensity Plasmacluster Ions only in the forward direction.
- Discharges stronger air for 8 hours. When the operation finishes, the main unit will return to its prior operation mode.
- The Plasmacluster Ion can not be turned "OFF".

SELECTING MODE

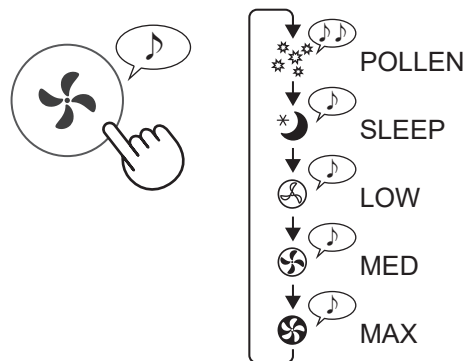

SLEEP :

The main unit will operate quietly, and the fan speed is automatically switched depending on the amount of impurities in the air. The Front Display and Cleanliness Monitor go off automatically.

POLLEN :

The DUST SENSOR sensitivity is automatically increased and quickly detects impurities such as dust and pollen and clean the air powerfully.

ON TIMER

Select the length of time you want.
The Main Unit automatically starts once the selected time is passes.

(with the Main Unit OFF)

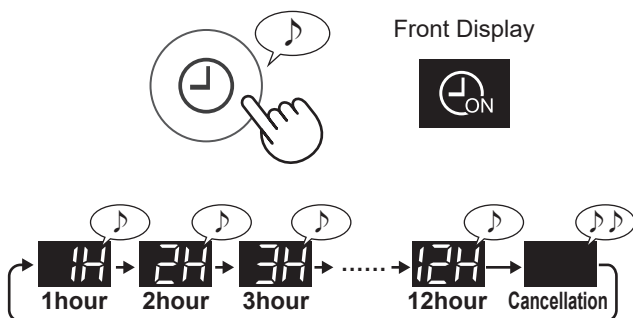

OFF TIMER

Select the length of time you want.
The Main Unit automatically stops once the selected time is reached.

(with the Main Unit ON)

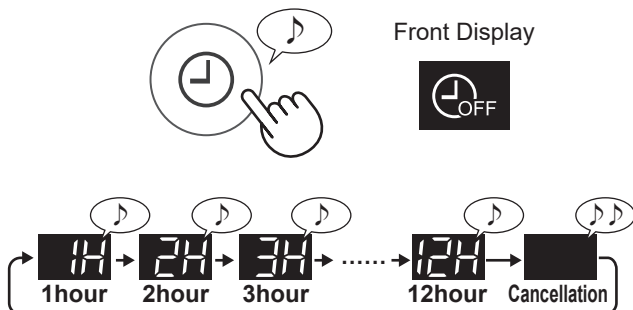

CHILD LOCK

The operation panel will be locked.

ON

Touch 3 sec.

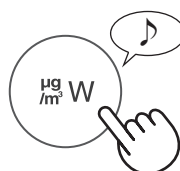

more 3 sec.

CANCELLATION

Touch 3 sec.



more 3 sec.

SELECTING DISPLAY

(with the Main Unit ON)

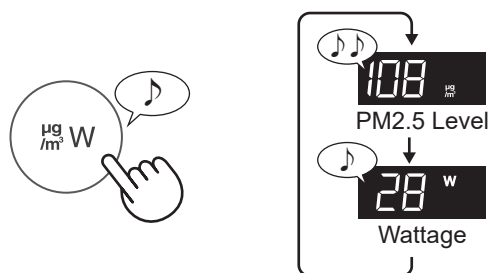

PLASMACLUSTER ION ON/OFF

When the Plasmacluster function is ON, the Plasmacluster Ion light is on. (Page 7)

(with the Main Unit ON)

ON



more 3 sec.

OFF



more 3 sec.

HOW TO CHANGE VARIOUS SETTINGS

You can change the functions listed in the table below.

1. Turn the Main Unit power OFF.

2.



3. Select "Function number".

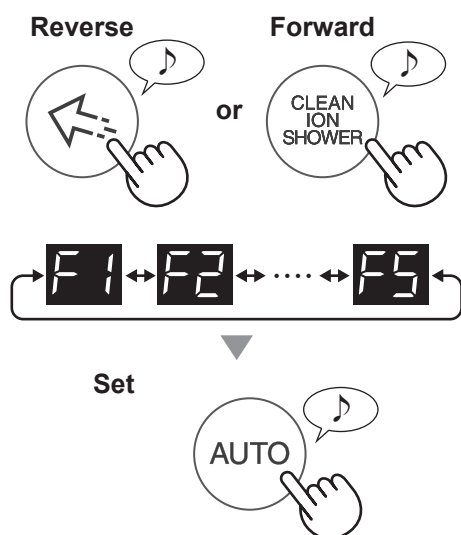

4. Select "Setting number".

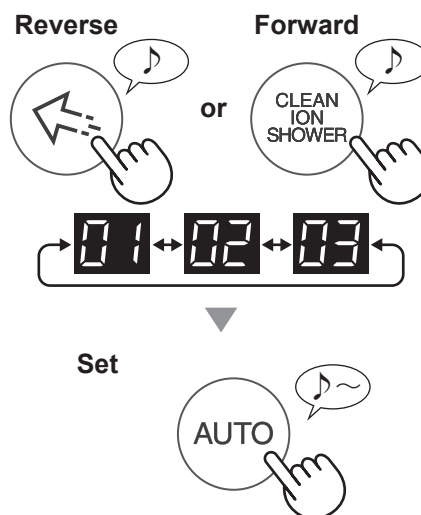

5. Press Power ON/OFF Button to finish the setting.



Function	Setting
Light Control You can select the brightness of the Front Display and Cleanliness Monitor.	<div> <div>01</div> Turn off * </div> <div> <div>02</div> Darker </div> <div> <div>03</div> Auto (default) Light automatically switches ON or OFF based on room brightness. Room is bright : light is ON Room is dark : light is OFF </div>
Auto Restart If the Main Unit is unplugged or if there is a power failure, the Main Unit will resume operation with the previous settings after power is restored.	<div> <div>01</div> Cancellation </div> <div> <div>02</div> ON (default) </div>
Adjusting Sensor Sensitivity (F3 - F5)	
Light Sensor	<div> <div>01</div> Low </div>
Dust(sensitive) Sensor	<div> <div>02</div> Standard (default) </div>
Odor Sensor	<div> <div>03</div> High </div>

* When set to "Turn off", the "Darker" light illuminates for 8 seconds after operation starts and then the light turns off.

TROUBLESHOOTING

Before calling for service, please review the list below, since the problem may not be the product malfunction.

Odor and smoke persists.

- Check the filters. If they appear to be extremely dirty, clean or replace them.
- Check if the plastic bag is removed from the filter. (Page 8)

The Cleanliness Monitor is blue even when the air is not clean.

- The air may have been dirty when the main unit was plugged in. Unplug the main unit, wait one minute, and then plug the main unit in again.

The Cleanliness Monitor light is red even when the air is clean.

- Dirty or clogged dust(sensitive) sensor openings interfere with sensor operation. Gently clean the sensor filter or the back panel.

The Main Unit makes a clicking or ticking sound.

- The main unit may make clicking or ticking sounds when it is generating ions.

Air discharged from the Main Unit has an odor.

- Check to see if the filters are extremely dirty.
- Clean or replace the filters.

The Main Unit does not operate when cigarette smoke is in the air.

- Make sure the Main Unit is installed in a location in which the sensors can detect cigarette smoke.
- Check to see if the dust(sensitive) sensor openings are blocked or clogged. If they are blocked or clogged, clean the sensor filter or the back panel.

Smell from a new unit and/or filter.

- Immediately after removing the plastic bag, a slight odor may occur. This odor is not harmful for filter performance or human exposure.

The FILTER Replacement Indicator Light is flashing.

- Whenever after performing replacing the filters, connect the power cord to an outlet and then press the Filter Reset Button. (Page 5)

The Front Display is turned off.

- When Light control is set to "Auto", the light automatically turns off when the room is dark. Moreover, when Light control is set to "Turn off", the light is always off. If you do not want the light to be off, set Light control to the "Darker" setting. (Page 11)



The Cleanliness Monitor changes color frequently.

- The Cleanliness Monitor automatically changes color when the dust(sensitive) sensor and odor sensor detect impurities. If you are concerned about the change, you can change sensor sensitivity. (Page 11)

The Main Unit's Display does not match weather report.

- Outdoor and indoor as well as the home environment (the volume of traffic nearby, number of stories in home, etc.) may cause a reading different than those data.
- There is a difference in the level within the same room.

ERROR DISPLAY

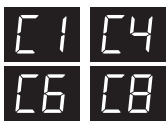
	<ul style="list-style-type: none"> • The concentration of Plasmacluster ion is descending. ⇒ Maintain the Plasmacluster Ion Generating Unit (electrode section).
	<ul style="list-style-type: none"> • Is the Plasmacluster Ion Generating Unit inserted properly? ⇒ Pull out the Plasmacluster Ion Generating Unit and insert it to the end again, and then carry out the operation again.
	<ul style="list-style-type: none"> • Unplug the Main Unit, wait one minute, and then plug the Main Unit in again.

SPECIFICATIONS

Model		FX-J80J		
Power supply		220 - 240 V 50 - 60 Hz		
Fan Speed Adjustment		MAX	MED	LOW
Fan Speed (m³/h)		480	288	60
Noise Level (dBA) *1		47	45	15
Rated Power (W)		48	28	4.0
Standby Power (W)		1.3		
Recommended Room Size (m²)	(JEM1467)*2	~ 62		
	(NRCC)*3	~ 127.89		
CADR (GB/T18801-2015) smoke (m³/h)		491.9		
High density Plasmacluster ion recommended room size (m²) *4		~ 35		
Filter type		HEPA*5 / Deodorizing		
Cord Length (m)		2.0		
Dimensions (mm)		416 (W) × 291 (D) × 728 (H)		
Weight (kg)		10.6		

*1 • Noise level is measured based on the JEM 1467 standard of the Japan Electrical Manufacturers' Association.

*2 • The recommended room size is appropriate for operating the main unit of maximum fan speed.

• The recommended room size is an area in which a given amount of dust particles can be removed in 30 minutes (according to standards of the Japan Electrical Manufacturers' Association (JEM1467)).

*3 • NRCC is designed by the National Research Council of Canada. The NRCC applicable area is calculated based on the CADR of the GB/T18801-2015.

*4 • Room size in which approximately 25000 ions per cubic centimeter can be measured in the center of the room when the main unit is placed next to a wall, is running at MED mode settings, and is at a height of approximately 1.2 meters from the floor.

*5 • The filter removes more than 99.97% of particles at least 0.3 microns in size (according to standards of the Japan Electrical Manufacturers' Association (JEM1467)).

Standby Power

When the main unit's power plug is inserted in a wall outlet it consumes standby power in order to operate electrical circuits. To conserve energy, unplug the power cord when the main unit is not in use.

FOR CUSTOMER ASSISTANCE

SHARP WARRANTY

Consumer Electronic Products

Congratulations on Your Purchase!

This Sharp product is warranted against faults in material and manufacture for the period as stated in the table below.

If service is required during the warranty period, please contact your nearest Sharp Approved Service Centre. These repairs would be carried out at no charge to the owner, subject to the conditions specified herein.

This warranty does not extend to defects or injuries caused by or resulting from causes not attributable to faulty parts or the manufacture of the product, including but not limited to, defect or injury caused by or resulting from misuse, abuse, neglect, lack of maintenance, accidental damage, improper voltage, liquid spillage, vermin infestation, software, or any alterations made to the product which are not authorised by Sharp.

Please retain your sales documentation, as this should be produced to validate a warranty claim. This warranty is in addition to and in no way limits, varies or excludes any implied rights and remedies under any relevant legislation in the country of sale.

This warranty does not cover transportation to and from the Sharp Approved Service Centre. Goods presented for repair may be replaced by refurbished goods of the same type rather than being repaired. Refurbished parts may be used to repair the goods. The repair of your goods may result in the loss of user generated data, please ensure that you have saved this data elsewhere prior to repair.

Australian customers: Our goods come with guarantees that cannot be excluded under the Australian Consumer Law. You are entitled to a replacement or refund for a major failure and for compensation for any other reasonably foreseeable loss or damage. You are also entitled to have the goods repaired or replaced if the goods fail to be of acceptable quality and the failure does not amount to a major failure. The criteria of a major failure is defined in the Australian Consumer Law. Should you require any assistance with a major failure please contact Sharp Customer Care.

WARRANTY PERIODS

Air Purifier	12 months
--------------	-----------

IMPORTANT NOTICE: This warranty applies only to products sold in Australia & New Zealand

SHARP

FOR LOCATION ENQUIRIES WITHIN

AUSTRALIA

REGARDING YOUR LOCAL

SHARP APPROVED SERVICE CENTRE

Customer service helplines

1300 742 770

(calling within Australia)

Monday - Saturday, 9am - 6pm

Open Monday to Saturday except on public holidays.

Distributed by

Tempo (Aust) Pty Ltd

PO Box 132 Frenchs Forest NSW 1640 Australia

info@tempo.org

For an electronic copy of this manual, please contact our after sales support centre.

SHARP

FOR LOCATION ENQUIRIES WITHIN

NEW ZEALAND

REGARDING YOUR LOCAL

SHARP APPROVED SERVICE CENTRE

VISIT OUR WEBSITE AT

www.sharp.net.nz

CONTACT YOUR SELLING DEALER/RETAILER

OR CALL

SHARP CUSTOMER SERVICES

TELEPHONE: 09 573 0111

FACSIMILE: 09 573 0113

SHARP CORPORATION OF NEW ZEALAND LIMITED

MEMO

MEMO

SHARP

SHARP CORPORATION
OSAKA, JAPAN